

gebo press

MADE OF STAINLESS STEEL

**NEW
PRODUCT**
**GEBOPRESS
FITTINGS**

gebo
FITS BETTER!



**FOR PERFECT
CONNECTIONS -
DURABLE AND RELIABLE**

better. easier. faster.

GEBO has been dedicated to a clear vision: to improve, simplify and speed up the work of installers through smart solutions.

Our aim is to offer high-quality and long-lasting systems that enable efficient and effective work. We set standards in the development, production and sale of systems for pipe connections and repairs, specializing in steel, polyethylene, copper and multilayer composite pipes.

Our products are used every day throughout Europe in the public, private and industrial sectors. Our solutions are designed to provide installers with the best tools, which is why GEBO stands for quality and reliability.

press-fitting.gebo.group



gebopress

With the development of the malleable cast iron clamp connector **GEBO** revolutionized the market almost 90 years ago and enabled installers to work faster and easier for the first time.

Since then, **GEBO** has continuously expanded with innovative solutions.

Always with a clear vision:

To make the work of plumbers more efficient, easier and more efficient, simpler and faster.

The introduction of gebopress is the logical further development of this claim.

GEBO Pressfittings made of stainless steel



M CONTOUR



SUPER CORROSION
RESISTANT



RELIABLE, SECURE AND
DURABLE SEALING



WIDE RANGE
FROM 15 MM UNTIL 54 MM



DVGW CERTIFICATE FOR DRINKING
WATER APPLICATIONS



HOT/COLD
DRINKING WATER



HEATING
SYSTEMS



COMPRESSED
AIR

PRESSFITTING – Made of stainless steel - 316L

APPLICABLE FIELDS:

Hot/cold drinking water, heating Systems, Compressed air

PROFILE:

M Contour

MATERIAL:

stainless steel (316L)

SEALING:

EPDM

MEDIA:

water, compressed air

PRESSURE:

For water 16 bar,

TEMPERATURE:

For water -18 °C to 110 °C

CONNECTION STANDARD:

For stainless steel tubes in compliance with EN10312 (series 1 or series 2)

CERTIFICATION:

DVGW Certificate for drinkingwater applications for 15-108 mm

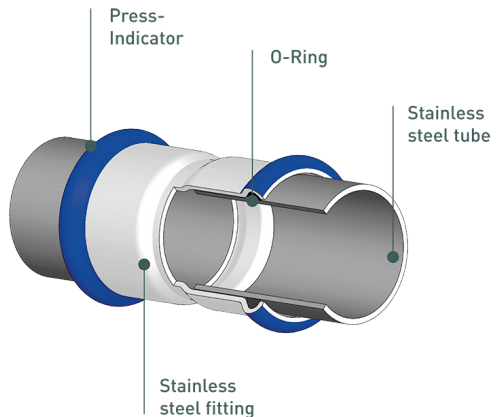

Assembly of the GEBOPRESS Fittings

The pipe connection with gebopress is quick and clean as usual.

Shortening the pipe

Cut the pipe perpendicular to the axis using a pipe cutter. Make sure to take into account the insertion depth of the fitting in the connecting piece.



Deburring and Calibrating the pipe

Carefully deburr the inside and outside of the pipe using a deburring tool. This will prevent the sealing ring from being damaged when you push the pipe into the fitting. Remove all burrs completely and cleanly.

Mark the insertion depth

Mark the insertion depth on the pipe to ensure a secure connection. This allows you to detect any possible displacements before or after pressing.



Pressing

Use an M-profile jaw for pressing. Observe the minimum pressing force. Only carry out the pressing process once - repeated pressing can impair the tightness. Do not interrupt the process. Remove the pressing indicator immediately after pressing.



**SOLUTION THAT MAKES LIFE
EASIER FOR INSTALLERS**

ELBOW GROUP – Made of stainless steel - 316L

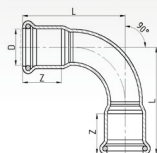

GEBOPRESS 90° ELBOW

Dimension D	Code	L [MM]	Z [MM]	Weight [KG]	PCS per Bag
15	6P02A-BME	49	20	0,0552	40
18	6P02A-CME	53	20	0,0702	20
22	6P02A-DME	62	21	0,0988	20
22	6P02A-EME	72	23	0,1425	10
35	6P02A-FME	85	26	0,2074	5
42	6P02A-GME	110	30	0,3294	5
54	6P02A-HME	134	35	0,5119	2
76,1	6P02A-JME*	188	53	1,3504	1
88,9	6P02A-KME*	218	60	1,8268	1
108	6P02A-LME*	260	75	2,6461	1

* Sizes on request

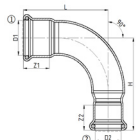

GEBOPRESS REDUCING 90° ELBOW

Dimension D1 x D2	Code	L [MM]	H [MM]	Z1 [MM]	Z2 [MM]	Weight [KG]	PCS per Bag
22 x 18	6P002-DCME	54	55	21	20	0,0947	15
28 x 22	6P002-EDME	64	66	23	21	0,14	10
35 x 28	6P002-FEME	75	80	26	23	0,2003	5
42 x 35	6P002-GFME	89	91,5	30	26	0,3112	5
54 x 42	6P002-HGME	108	115	35	30	0,49	2

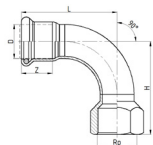

GEBOPRESS 90° ELBOW WITH FEMALE THREAD

Dimension D x Rp	Code	L [MM]	H [MM]	Z [MM]	Weight [KG]	PCS per Bag
18 x 1/2"	6P002-C04ME	51	48,5	20	0,1003	25
22 x 3/4"	6P002-D05ME	54	52	21	0,13	15
28 x 1"	6P002-E06ME	64	66	23	0,1878	10
35 x 1 1/4"	6P002-F07ME	75	73,5	26	0,2765	6
42 x 1 1/2"	6P002-G08ME	89	83	30	0,40	4
54 x 2"	6P002-H09ME*	108	101	35	0,66	2

* Sizes on request

ELBOW GROUP – Made of stainless steel - 316L

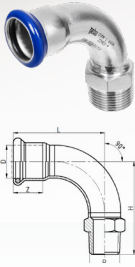

GEBOPRESS 90° ELBOW WITH MALE THREAD

Dimension D x R	Code	L [MM]	H [MM]	Z [MM]	Weight [KG]	PCS per Bag
22 x 3/4"	6P001-D05ME	54	55,5	21	0,1235	20
28 x 1"	6P001-E06ME	64	69	23	0,1875	10
35 x 1 1/4"	6P001-F07ME	75	77,5	26	0,2699	6
42 x 1 1/2"	6P001-G08ME	89	89	30	0,3993	4
54 x 2"	6P001-H09ME	108	108	35	0,6346	2

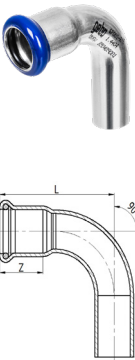

GEBOPRESS 90° ELBOW WITH PLAIN END

Dimension D	Code	L [MM]	H [MM]	Z [MM]	Weight [KG]	PCS per Bag
15	6P001-BME	43	44	20	0,0488	45
18	6P001-CME	52	59	20	0,0678	30
22	6P001-DME	60	67	21	0,0966	25
28	6P001-EME	71	78	23	0,1404	10
35	6P001-FME	84	120	26	0,2396	5
42	6P001-GME	110	140	30	0,3555	5
54	6P001-HME	136	165	35	0,5454	4
76,1	6P001-JME*	188	247	53	1,5002	1
88,9	6P001-KME*	218	292	60	2,0598	1
108	6P001-LME*	258	358	75	3,0399	1

* Sizes on request



GEBOPRESS 45° ELBOW

Dimension D	Code	L [MM]	Z [MM]	Weight [KG]	PCS per Bag
15	6P041-BME	32	20	0,0444	50
18	6P041-CME	34	20	0,0569	40
22	6P041-DME	42	21	0,0794	25
28	6P041-EME	48	23	0,1109	15
35	6P041-FME	53	26	0,1552	10
42	6P041-GME	65	30	0,2236	5
54	6P041-HME	78	35	0,3371	5
76,1	6P041-JME*	123	53	1,0191	1
88,9	6P041-KME*	139	60	1,3649	1
108	6P041-LME*	164	75	1,981	1

* Sizes on request

ELBOW GROUP – Made of stainless steel - 316L

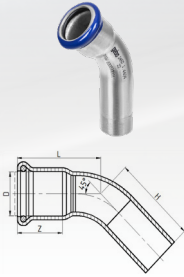

GEBOPRESS 45° ELBOW WITH PLAIN END

Dimension D	Code	L [MM]	H [MM]	Z [MM]	Weight [KG]	PCS per Bag
15	6P040-BME	32	40	20	0,0384	50
18	6P040-CME	36	41	20	0,0531	35
22	6P040-DME	42	47	21	0,0763	20
28	6P040-EME	48	53	23	0,1086	13
35	6P040-FME	53	79	26	0,1762	7
42	6P040-GME	63	97	30	0,3555	5
54	6P040-HME	76	125	35	0,5454	5
76,1	6P040-JME	123	188	53	1,5002	1
88,9	6P040-KME	139	225	60	2,0598	1
108	6P040-LME	164	275	75	3,0399	1

TEE GROUP – Made of stainless steel - 316L

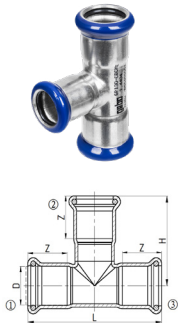

GEBOPRESS EQUAL TEE

Dimension D	Code	L [MM]	H [MM]	Z [MM]	Weight [KG]	PCS per Bag
15 x 15 x 15	6P130-BME	67	33,5	20	0,0638	25
18 x 18 x 18	6P130-CME	68	42	20	0,0804	20
22 x 22 x 22	6P130-DME	74	45	21	0,1063	15
28 x 28 x 28	6P130-EME	84	52	23	0,1455	10
35 x 35 x 35	6P130-FME	98	58	26	0,1992	5
42 x 42 x 42	6P130-GME	112	63	30	0,2729	3
54 x 54 x 54	6P130-HME	136	78	35	0,4125	5
76.1 x 76.1 x 76.1	6P130-JME*	230	108	53	1,2604	1
88.9 x 88.9 x 88.9	6P130-KME*	260	125	60	1,6826	1
108 x 108 x 108	6P130-LME*	310	147	75	2,4573	1

* Sizes on request

TEE GROUP – Made of stainless steel - 316L

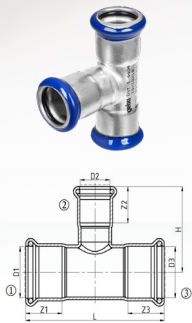

GEBOPRESS REDUCING TEE

Dimension D1 x D2 x D3	Code	L [MM]	H [MM]	Z 1 [MM]	Z2 [MM]	Z3 [MM]	Weight [KG]	PCS per Bag
18 x 15 x 18	6P130-CBCME	68	35	20	20	20	0,0726	20
22 x 15 x 22	6P130-DBDME	74	37,5	21	20	21	0,0919	10
22 x 18 x 22	6P130-DCDME	74	44	21	20	21	0,0992	15
28 x 15 x 28	6P130-EBEME	84	40,5	23	20	23	0,1201	10
28 x 18 x 28	6P130-ECEME	84	47	23	20	23	0,13	10
28 x 22 x 28	6P130-EDEME	84	48	23	21	23	0,1342	10
35 x 15 x 35	6P130-FBFME	98	43	26	20	26	0,1604	5
35 x 18 x 35	6P130-FCFME	98	49,5	26	20	26	0,1605	5
35 x 22 x 35	6P130-FDFME	98	50,5	26	21	26	0,1744	5
35 x 28 x 35	6P130-FEFME	98	54,5	26	23	26	0,1853	5
42 x 15 x 42	6P130-GBGME	112	46,5	30	20	30	0,218	5
42 x 18 x 42	6P130-GCGME	112	53	30	20	30	0,2252	5
42 x 22 x 42	6P130-GDGME	112	54	30	21	30	0,2318	5
42 x 28 x 42	6P130-GEGME	112	58	30	23	30	0,2425	5
42 x 35 x 42	6P130-GFGME	112	61	30	26	30	0,2554	5
54 x 15 x 54	6P130-HBHME	136	52,5	35	20	35	0,323	5
54 x 18 x 54	6P130-HCHME	136	59	35	20	35	0,33	5
54 x 22 x 54	6P130-HDHME	136	60	35	21	35	0,1776	5
54 x 28 x 54	6P130-HEHME	136	64	35	23	35	0,1777	5
54 x 35 x 54	6P130-HFHME*	136	67	35	26	35	0,3595	5
54 x 42 x 54	6P130-HGHME*	136	68,5	35	30	35	0,3752	2
76.1 x 22 x 76.1	6P130-JDJME*	230	72	53	21	53	1,0105	1
76.1 x 28 x 76.1	6P130-JEJME*	230	76	53	23	53	1,0198	1
76.1 x 35 x 76.1	6P130-JFJME*	230	79,5	53	26	53	1,0311	1
76.1 x 42 x 76.1	6P130-JGJME*	230	81	53	30	53	1,0446	1
76.1 x 54 x 76.1	6P130-JHJME*	230	90,5	53	35	53	1,0751	1
88.9 x 22 x 88.9	6P130-KDKME*	260	78,5	60	21	60	1,3285	1
88.9 x 28 x 88.9	6P130-KEKME*	260	82,5	60	23	60	1,34	1
88.9 x 35 x 88.9	6P130-KFKME*	260	86	60	26	60	1,3492	1
88.9 x 42 x 88.9	6P130-KGKME*	260	87,5	60	30	60	1,3632	1
88.9 x 54 x 88.9	6P130-KHKME*	260	97	60	35	60	1,3937	1
88.9 x 76.1 x 88.9	6P130-KJKME*	260	116	60	53	60	1,58	1
108 x 22 x 108	6P130-LDLME*	310	88	75	21	75	1,9365	1
108 x 28 x 108	6P130-LELME*	310	92	75	23	75	1,9457	1
108 x 35 x 108	6P130-LFLME*	310	95,5	75	26	75	1,958	1
108 x 42 x 108	6P130-LGLME*	310	97	75	30	75	1,9712	1
108 x 54 x 108	6P130-LHLME*	310	107	75	35	75	1,9992	1
108 x 76.1 x 108	6P130-LJLME*	310	126	75	53	75	2,1846	1

* Sizes on request

TEE GROUP – Made of stainless steel - 316L

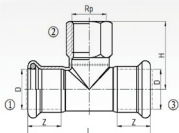

GEBOPRESS FEMALE THREAD EQUAL TEE

Dimension D x Rp x D	Code	L [MM]	H [MM]	Z [MM]	Weight [KG]	PCS per Bag
15 x 1/2" x 15	6P130-B04BME	67	33,5	20	0,0819	20
18 x 1/2" x 18	6P130-C04CME	68	35,5	20	0,1059	20
22 x 3/4" x 22	6P130-D05DME	74	39,5	21	0,1276	15
28 x 1" x 28	6P130-E06EME	84	46,5	23	0,1821	8
35 x 1 1/4" x 35	6P130-F07FME	98	50,5	26	0,2629	5
42 x 1 1/2" x 42	6P130-G08GME	112	54	30	0,35	3
54 x 2" x 54	6P130-H09HME	136	65	35	0,5538	2
18 x 3/4" x 18	6P130-C05CME	68	37,5	20	0,10	15
22 x 1/2" x 22	6P130-D04DME	74	37,5	21	0,1247	15
28 x 1/2" x 28	6P130-E04EME	84	40,5	23	0,1529	10
28 x 3/4" x 28	6P130-E05EME	84	42,5	23	0,1555	10
35 x 1/2" x 35	6P130-F04FME	98	43	26	0,1935	5
35 x 3/4" x 35	6P130-F05FME	98	45	26	0,1957	5
35 x 1" x 35	6P130-F06FME	98	49,5	26	0,2219	5
42 x 1/2" x 42	6P130-G04GME	112	46,5	30	0,2507	5
42 x 3/4" x 42	6P130-G05GME	112	48,5	30	0,2531	5
42 x 1" x 42	6P130-G06GME	112	52,5	30	0,2791	5
54 x 1/2" x 54	6P130-H04HME	136	52,5	35	0,3556	5
54 x 3/4" x 54	6P130-H05HME	136	54,5	35	0,3578	5
54 x 1" x 54	6P130-H06HME	136	58,5	35	0,3836	5
76 x 3/4" x 76	6P130-J05JME*	230	65,5	53	1,0318	1
76 x 2" x 76	6P130-J09JME*	230	77,5	53	1,2164	1
89 x 3/4" x 89	6P130-K05KME*	260	73	60	1,3498	1
89 x 2" x 89	6P130-K09KME*	260	84	60	1,535	1
108 x 3/4" x 108	6P130-L05LME*	310	82,5	75	1,9578	1
108 x 2" x 108	6P130-L09LME*	310	93,5	75	2,1405	1

* Sizes on request

TEE GROUP – Made of stainless steel - 316L

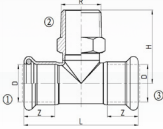

GEBOPRESS EQUAL TEE WITH MALE THREAD

Dimension D x R x D	Code	L [MM]	H [MM]	Z [MM]	Weight [KG]	PCS per Bag
18 x 1/2" x 18	6P133-C04CME	68	39,5	20	0,09	25
22 x 3/4" x 22	6P133-D05DME	74	43	21	0,1262	15
28 x 1" x 28	6P133-E06EME	84	49,5	23	0,1816	8
35 x 1 1/4" x 35	6P133-F07FME	98	54,5	26	0,26	5
42 x 1 1/2" x 42	6P133-G08GME	112	60	30	0,34	3
54 x 2" x 54	6P133-H09HME	136	72	35	0,53	2
22 x 1/2" x 22	6P133-D04DME*	74	41,5	21	0,11	15
28 x 3/4" x 28	6P133-E05EME*	84	46	23	0,15	10
35 x 1" x 35	6P133-F06FME*	98	52	26	0,22	5

* Sizes on request

COUPLING GROUP – Made of stainless steel - 316L

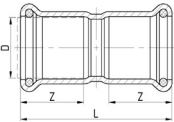

GEBOPRESS EQUAL COUPLING

Dimension D	Code	L [MM]	Z [MM]	Weight [KG]	PCS per Bag
15	6P272-BME	48,5	20	0,0361	60
18	6P272-CME	53	20	0,04	45
22	6P272-DME	51	21	0,06	35
28	6P272-EME	54	23	0,0724	20
35	6P272-FME	64	26	0,104	5
42	6P272-GME	73	30	0,1381	6
54	6P272-HME	85	35	0,2003	5
76,1	6P272-JM*	141	53	0,65	1
88,9	6P272-KME*	162	60	0,8685	1
108	6P272-LME*	194	75	1,2864	2

* Sizes on request

COUPLING GROUP – Made of stainless steel - 316L

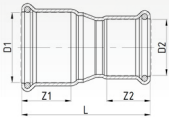

GEBOPRESS REDUCING COUPLING

Dimension D1 x D2	Code	L [MM]	Z1 [MM]	Z2 [MM]	Weight [KG]	PCS per Bag
22 x 18	6P240-DCME	57,5	21	20	0,0545	35
28 x 22	6P240-EDME	60	23	21	0,0702	20
35 x 28	6P240-FEME	69,5	26	23	0,0978	15
42 x 35	6P240-GFME	76	30	26	0,1315	10
54 x 42	6P240-HGME	93	35	30	0,20	5
76.1 x 54	6P240-JHME*	129	53	35	0,4842	2
88.9 x 54	6P240-KHME*	142	60	35	0,6222	1
88.9 x 76.1	6P240-KJME*	159	60	53	0,7902	1
108 x 54	6P240-LHME*	160	75	35	0,8653	1
108 x 88.9	6P240-LKME*	189,5	75	60	1,137	1

* Sizes on request

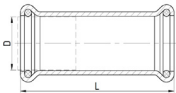

GEBOPRESS SLIP COUPLING

Dimension D	Code	L [MM]	Weight [KG]	PCS per Bag
18	6P270-CME	68	0,06	35
22	6P270-DME	74	0,0759	20
28	6P270-EME	84	0,1046	15
35	6P270-FME	98	0,1479	10
42	6P270-GME	112	0,2062	5
54	6P270-HME	136	0,3126	2
76,1	6P270-JME*	230	1,0062	2
88,9	6P270-KME*	260	1,3281	1
108	6P270-LME*	310	1,9432	1

* Sizes on request

COUPLING GROUP – Made of stainless steel - 316L

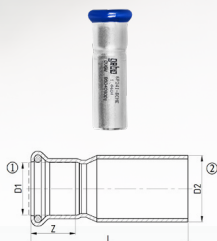

GEBOPRESS REDUCING COUPLING WITH PLAIN END

Dimension D1 x D2	Code	L [MM]	Z [MM]	Weight [KG]	PCS per Bag
15 x 18	6P241-BCME	63,5	20	0,042	20
15 x 22	6P241-BDME	70,5	20	0,0535	10
18 x 22	6P241-CDME	68	20	0,0545	10
15 x 28	6P241-BEME*	76	20	0,0693	20
18 x 28	6P241-CEME*	77	20	0,073	10
22 x 28	6P241-DEME	71	21	0,073	10
15 x 35	6P241-BFME*	81	20	0,09	15
18 x 35	6P241-CFME*	83	20	0,09	15
22 x 35	6P241-DFME*	81	21	0,0981	5
28 x 35	6P241-EFME*	82,5	23	0,1044	15
15 x 42	6P241-BGME*	92,5	20	0,12	10
18 x 42	6P241-CGME*	93	20	0,12	10
22 x 42	6P241-DGME*	91,5	21	0,129	10
28 x 42	6P241-EGME*	91,5	23	0,1346	5
35 x 42	6P241-FGME	92,5	26	0,1416	5
15 x 54	6P241-BHME*	102	20	0,17	12
18 x 54	6P241-CHME*	104	20	0,18	12
22 x 54	6P241-DHME*	101	21	0,1784	5
28 x 54	6P241-EHME*	101	23	0,1839	5
35 x 54	6P241-FHME*	104	26	0,1954	5
42 x 54	6P241-GHME*	108	30	0,2092	5
42 x 76.1	6P241-GJME*	126	30	0,4052	2
54 x 76.1	6P241-HJME*	130	35	0,427	1
54 x 88.9	6P241-HKME*	139	35	0,5293	2
76.1 x 88.9	6P241-JKME*	156	53	0,6973	1
54 x 108	6P241-HLME*	161	35	0,7424	2
76.1 x 108	6P241-JLME*	179	53	0,9305	2
89 x 108	6P241-KLME*	190,5	60	1,0141	2

* Sizes on request

COUPLING GROUP – Made of stainless steel - 316L

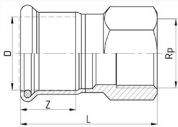

GEBOPRESS COUPLING WITH FEMALE THREAD

Dimension D x Rp	Code	L [MM]	Z [MM]	Weight [KG]	PCS per Bag
15 x 1/2"	6P272-B04ME	48	20	0,0535	50
18 x 1/2"	6P272-C04ME	50,5	20	0,0733	45
22 x 3/4"	6P272-D05ME	51,5	21	0,0814	35
28 x 1"	6P272-E06ME	57	23	0,1165	15
35 x 1 1/4"	6P272-F07ME	62	26	0,1723	10
42 x 1 1/2"	6P272-G08ME	67,5	30	0,2192	7
54 x 2"	6P272-H09ME	79	35	0,3604	5
76 x 2 1/2"	6P272-J10ME*	104	53	0,6839	2
15 x 3/8"	6P272-B03ME*	44	20	0,0373	50
15 x 3/4"	6P272-B05ME	50	20	0,0745	10
18 x 3/4"	6P272-C05ME	52,5	20	0,07	10
22 x 1/2"	6P272-D04ME	49,5	21	0,0764	30
22 x 1"	6P272-D06ME	55,5	21	0,113	10
28 x 3/4"	6P272-E05ME	53	23	0,1189	25
28 x 1 1/4"	6P272-E07ME	58	23	0,16	10
35 x 1"	6P272-F06ME	62	26	0,1278	15
42 x 2"	6P272-G09ME*	86	30	0,35	5
35 x 1 1/2"	6P272-F08ME*	63	26	0,1975	6
42 x 1 1/4"	6P272-G07ME*	67,5	30	0,1936	10
54 x 1 1/2"	6P272-H08ME*	74	35	0,4194	5

* Sizes on request

COUPLING GROUP – Made of stainless steel - 316L

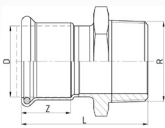

GEBOPRESS CUPLING WITH MALE THREAD

Dimension D x R	Code	L [MM]	Z [MM]	Weight [KG]	PCS per Bag
15 x 1/2"	6P246-B04ME	52	20	0,06	50
18 x 1/2"	6P246-C04ME	54,5	20	0,06	45
22 x 3/4"	6P246-D05ME	55	21	0,08	30
28 x 1"	6P246-E06ME	60	23	0,116	20
35 x 1 1/4"	6P246-F07ME	67	26	0,1657	10
42 x 1 1/2"	6P246-G08ME	73,5	30	0,2169	5
54 x 2"	6P246-H09ME	86	35	0,3392	5
76 x 2 1/2"	6P246-J10ME*	114	53	0,9225	1
89 x 3"	6P246-K11ME*	130	60	1,0115	1
15 x 3/8"	6P246-B03ME	49	20	0,04	50
15 x 3/4"	6P246-B05ME	53,5	20	0,0679	20
18 x 3/4"	6P246-C05ME	56	20	0,0746	35
22 x 1/2"	6P246-D04ME	53,5	21	0,077	35
22 x 1"	6P246-D06ME	58,5	21	0,107	10
28 x 3/4"	6P246-E05ME	56,5	23	0,1078	20
28 x 1 1/4"	6P246-E07ME	62	23	0,15	10
35 x 1"	6P246-F06ME*	65	26	0,1491	15
35 x 1 1/2"	6P246-F08ME*	69	26	0,21	5
42 x 1 1/4"	6P246-G07ME*	71,5	30	0,1792	5
54 x 1 1/2"	6P246-H08ME*	80	35	0,3201	5

* Sizes on request

UNION GROUP – Made of stainless steel - 316L

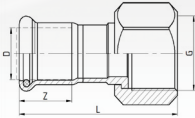

GEBOPRESS ADAPTOR WITH UNION NUT

Dimension D x G	Code	L [MM]	Z [MM]	Weight [KG]	PCS per Bag
15 x 1/2"	6P330-B04ME	47	20	0,04	50
18 x 1/2"	6P330-C04ME	47,5	20	0,07	50
22 x 3/4"	6P330-D05ME	53,5	21	0,08	30
28 x 1"	6P330-E06ME	58,5	23	0,11	20
35 x 1 1/4"	6P330-F07ME	64,5	26	0,15	12
42 x 1 1/2"	6P330-G08ME	74	30	0,22	8
54 x 2"	6P330-H09ME*	83	35	0,32	5

* Sizes on request

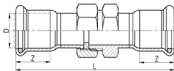

GEBOPRESS STRAIGHT UNION WITH PRESS FITTINGS

Dimension D	Code	L [MM]	Z [MM]	Weight [KG]	PCS per Bag
15	6P330-BME	89	20	0,11	25
18	6P330-CME	92	20	0,12	20
22	6P330-DME	99	21	0,13	10
28	6P330-EME	112	23	0,17	10
35	6P330-FME	119	26	0,19	5
42	6P330-GME	128	30	0,21	5
54	6P330-HME*	141	35	0,21	2

* Sizes on request

CAP – Made of stainless steel - 316L

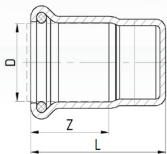

GEBOPRESS CAP

Dimension D	Code	L [MM]	Z [MM]	Weight [KG]	PCS per Bag
15	6P301-BME	30	20	0,0226	60
18	6P301-CME	34,5	20	0,03	60
22	6P301-DME	33,5	21	0,0378	50
28	6P301-EME	38	23	0,0506	40
35	6P301-FME	42	26	0,0707	20
42	6P301-GME	46,5	30	0,0979	5
54	6P301-HME	54	35	0,1466	5
108	6P301-LME*	105	75	0,8143	2

* Sizes on request

ELBOW ADAPTOR – Made of stainless steel - 316L

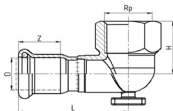

GEBOPRESS 90° BEARING PLATE ELBOW WITH FEMALE THREAD

Dimension D x Rp	Code	L [MM]	LH [MM]	Z [MM]	Weight [KG]	PCS per Bag
15 x 1/2"	6P471-B04ME	48,5	25	20	0,0882	25
18 x 1/2"	6P471-C04ME	48,5	25	20	0,10	20
22 x 3/4"	6P471-D05ME	55	30	21	0,1466	15

GEBO SEE KFT.
H-1044 Budapest
Ipari park u. 9
Hungary

T. +36 1 445 1760
F. +36 1 445 1770
E. info@gebo.hu
www.gebo.hu

